



//STROKE//

Contact Info:

info@strokeequipments.com

1800 313 3990

Assembly Unit:

Stroke Equipments India Pvt Ltd.,
No-2 Arun Warehouse,
No.1,2,3 Thandavamoorthy Street
Royapuram, Chennai - 600 013

Middle East:

Mr.Dil Nawaz Khan
Riyadh, KSA
nawaz@strokeequipments.com
+966 53 569 0532

Product

CATALOGUE

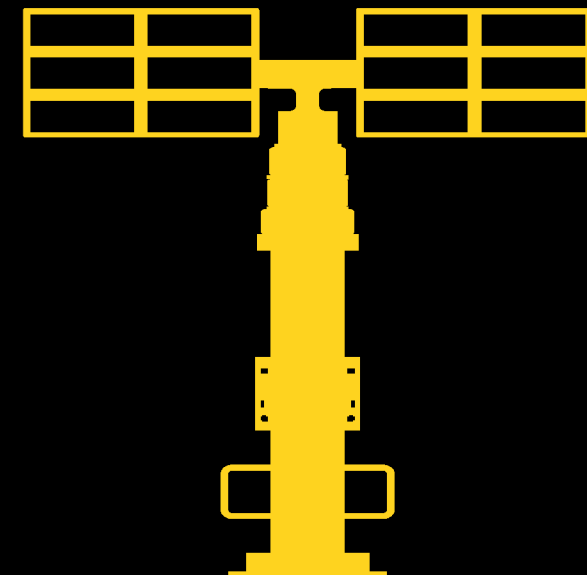

2
0
2
5

About Us

Innovative construction solutions and the highest quality of construction equipment make Stroke Equipments the preferred choice of industry experts globally. Setting gold standards with our light construction equipment, we are a force to be reckoned with in the fields of infrastructure and building construction.

Our illustrious journey began as a single unit manufacturing handmade engines for the agriculture sector. Over time, we have evolved into a prominent manufacturing and stocking conglomerate, catering to a premier clientele comprising leading infrastructure companies. Our products are synonymous with quality, economic viability, and durability, which is the key to our success as an ISO and CE certified company.

Nurtured by an ingenious team of devoted members obsessed with excellence, our brand is committed to providing reliable and safe equipment designed with the customer in mind. We are "Built To Perform."



History

Our company's rock-solid foundation was laid by our founding fathers, who built a family business with an unmatched reputation. As a family-run enterprise, we remain true to our core values, delivering impeccable service to our customers for decades. What began as a venture serving the agricultural sector has evolved into a leading conglomerate specializing in light construction equipment. Today, we are a global brand recognized and trusted by industries worldwide.

Vision

TO BE A LEAN GLOBAL ENTERPRISE PROVIDING SUSTAINABLE, INNOVATIVE CUSTOMER SOLUTION

Durable



Stroke equipment is designed to last and perform reliably under tough conditions without breaking down easily.

Economical



Minimizing waste: With over 90% of our products are made from recycled material, you can feel good about making a choice that's better for our planet.

Reliable



Stroke is dependable, trustworthy, and consistently performing well without failure. A reliable person, product, or system can be counted on to deliver expected results, maintain performance, and fulfill responsibilities over time.

Simple



Our equipment are something that is easy to understand, use, or do, without complexity or unnecessary complications. It implies straightforwardness, clarity, and minimal effort required for comprehension or execution.



LIGHTING SOLUTION

HALO 1

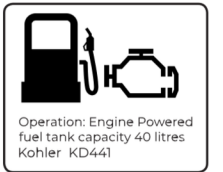
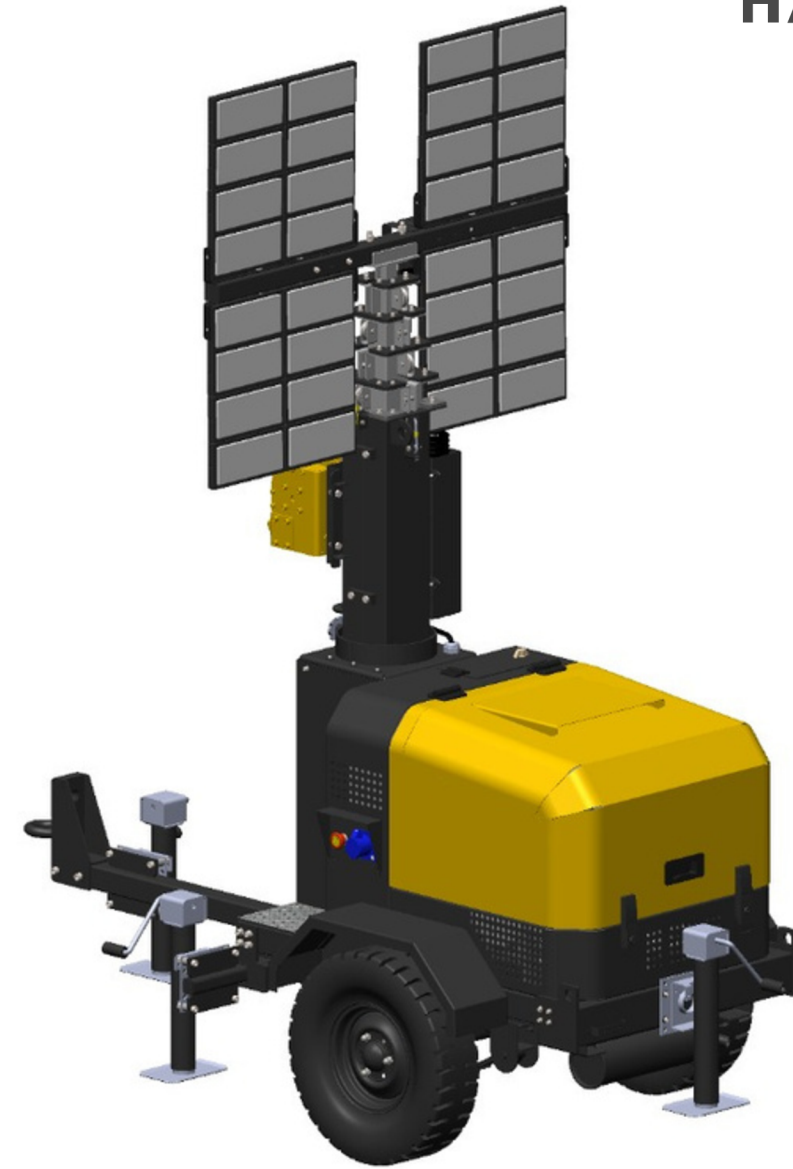

SPECIFICATION

Dimensions & Weight

Dimensions Min (mm)	Dimensions Max (mm)	Total Weight (kgs)
2215 x 1100 x 2630 (LxWxH)	2215 x 2225 x 9000 (LxWxH)	625

Projection Lights

Type	Power (Each)	No. of Lights	IP Level	Illuminated Area (Sqm)
LED	350 / 400W	Four	67	4400

Mast

Lifting Method	Max Height Type	Wind speed tolerance
Manual - Winch Type	8 mtrs	110 kms/hr

Alternator

Model	Rated Output	Rated Frequency	Rated Voltage
NSM / LINZ	4 KVA / 5 KVA	50 / 60 Hz	230 V

Engine

Model	Cylinder	Displacement	Engine Speed	Fuel Tank	Consumption	Sound DB Level	Avg Run-time	Cooling System
Kohler / Yanmar	Single	320 cm ³	3000-3600 Rpm	45 Ltrs	0.75 Ltrs / Hr	67	45 hrs	Air

SOLAR LIGHT TOWER

HALO-Lite

Illumination Data

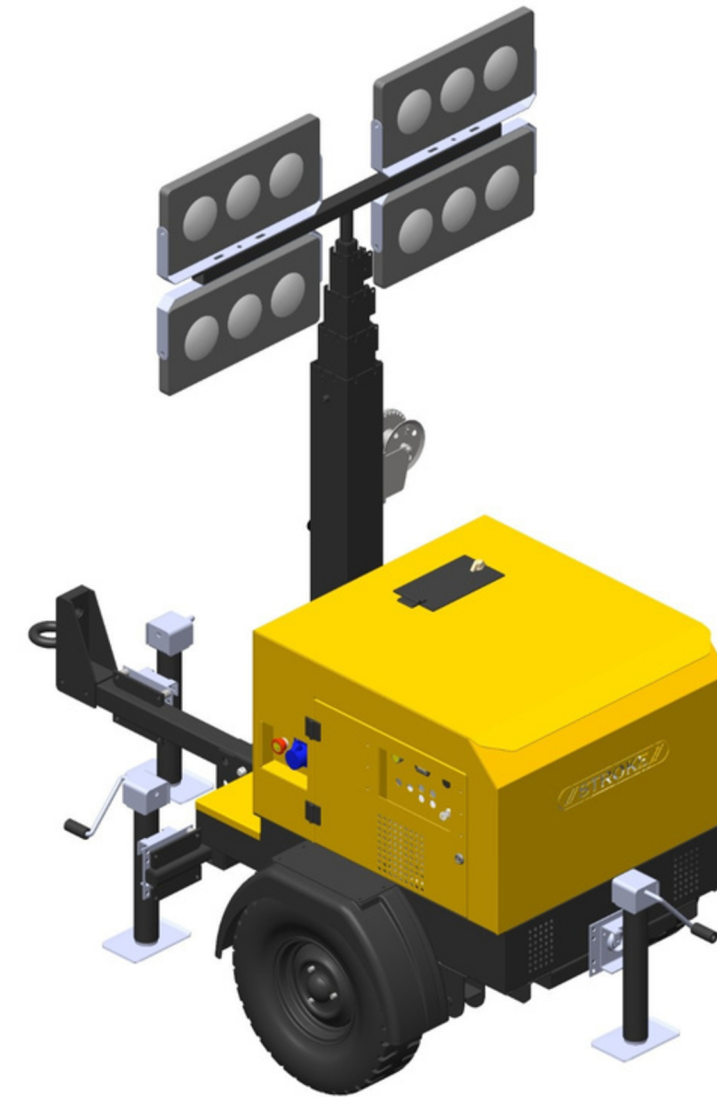
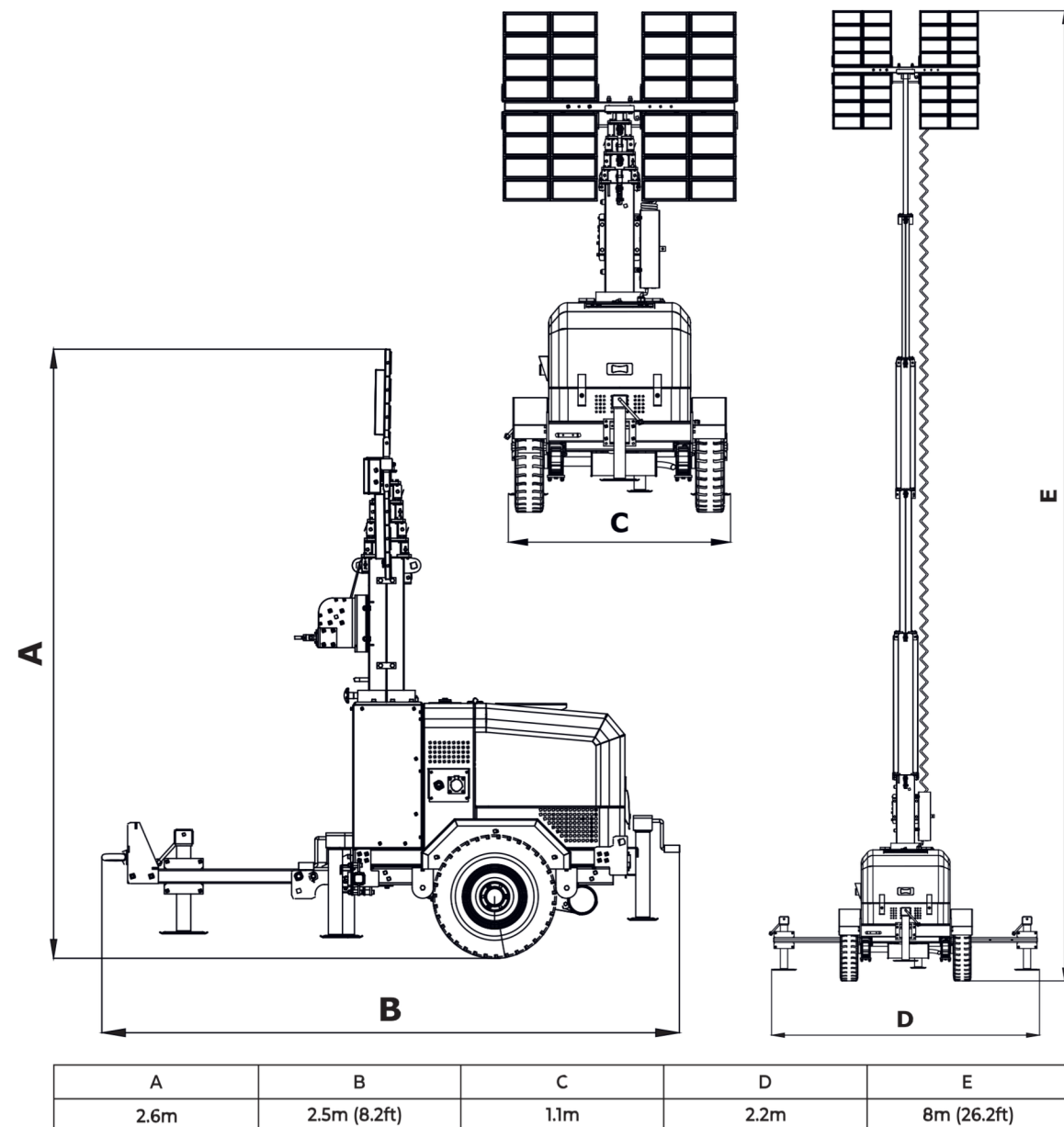
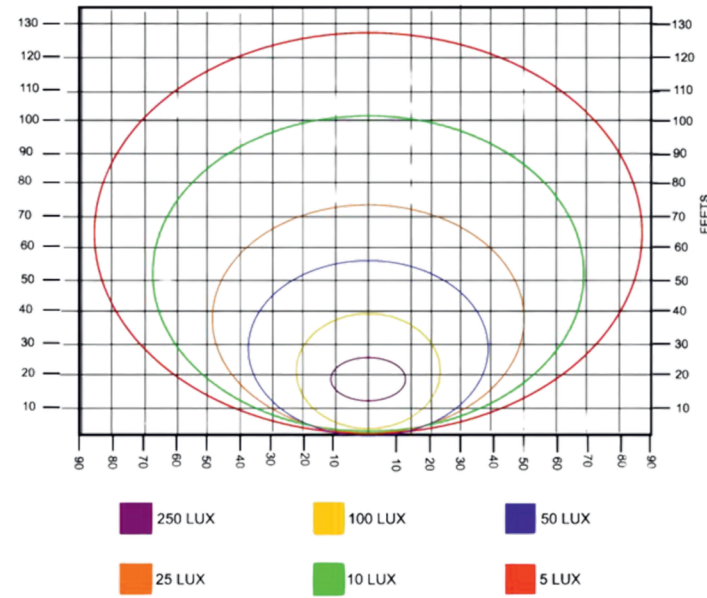

SPECIFICATION

Dimensions & Weight

Dimensions Min (mm)	Dimensions Max (mm)	Total Weight (kgs)
2215 x 1100 x 2630 (LxWxH)	2215 x 2225 x 9000 (LxWxH)	490

Projection Lights

Type	Power (Each)	No. of Lights	IP Level	Illuminated Area (Sqm)
LED	200 / 300W	Four	67	4400

Mast

Lifting Method	Max Height Type	Wind speed tolerance
Manual - Winch Type	6 mtrs	90 kms/hr

Alternator

Model	Rated Output	Rated Frequency	Rated Voltage
NSM / LINZ	3.5 kVA	50 / 60 Hz	230 V

Engine

Model	Cylinder	Displacement	Engine Speed	Fuel Tank	Consumption	Sound DB Level	Avg Run-time	Cooling System
Kohler	Single	320 cm ³	3000-3600 Rpm	30 Ltrs	0.75 Ltrs / Hr	80	30 hrs	Air

REBAR HANDLING SOLUTION

REBAR BENDING MACHINE

SPECIFICATION

Model No	BB 43	BB 53	BB 53 PRO
Prime Motor	3kw Motor (Elec)	4kw Motor (Elec)	5.56kw Motor (Elec)
Dimensions	800 x 720 x 900mm	860 x 760 x 900mm	950 x 800 x 1073mm
Mode of Operation	Automatic	Automatic, Planetary Gearbox	Automatic, Planetary Gearbox
Rotation Speed	7 r / min	13r / min	13r / min
Grade	TMT FE500 (upto 32mm)	TMT FE550 (upto 36mm)	TMT FE550 (upto 40mm)
Machine Weight	320 Kgs	460 Kgs	495 Kgs



Model No	BC 43	BC 53
Prime Motor	3kw Motor (Elec)	4kw Motor (Elec)
Dimensions	1260 x 480 x 650mm	860 x 760 x 900mm
Mode of Operation	Ergonomic Handle & Pedal	Ergonomic Handle & Pedal
Rebar Cutting Cycle	25 Cuts / min (up to 32mm)	32 Cuts / min (up to 36mm)
Machine Weight	420 Kgs	580 Kgs
Grade	TMT-FE500	TMT-FE550

SPECIFICATION

REBAR CUTTING MACHINE

With an unbeatable price-to-performance ratio, this rebar bending and cutting machine is ideal for handling high-tensile steel rods. Designed for power and precision, it delivers accurate bends and cuts, ensuring a flawless end product for the user.

CONCRETE CONSOLIDATION SOLUTION

CONCRETE VIBRATORS & POKERS

VIBRATOR

HAWK's unique selling point is its top-class maneuverability and user-friendly design.

SPECIFICATION

Model Name	HAWK
Weight (kgs)	5.8
Voltage	230
Frequency	50 / 60
RPM	12000
Power	3Hp / 2.23Kw
Dimensions	354 x 244 x 229mm



HAWK NEEDLE

Our concrete vibrator stands out for its top-class maneuverability and user-friendly operation, making it an ideal choice for efficient concrete work.

SPECIFICATION

Model Name	HNE25	HN40	HN60
Diameter (mm)	25	40	60
Length (mm)	285	335	344
Weight (kgs)	0.8	2.2	4.5
Speed (RPM)	14000	13500	12000
Performance m3/h	10	17	35



HIGH FREQUENCY CONVERTERS & POKERS



HFC



RAPTOR

Stroke Light Weight Converter - Shock-Proof, Water Resistant

SPECIFICATION

Model Name	HFC II	HFC IV	VHFC IV
Weight	32	68	68
Output	2 - Ports	4 - Ports	4 - Ports, Variable Speed
Power	3 Kw, 13 A	7 Kw, 10 A	7 Kw, 10 A
Voltage	230 V1 - 50Hz	415 V3 - 50/60Hz	415 V3 - 50/60Hz
Power	2 KVA 32A	5.45KVA 75-85A	2 KVA 32A
Volatage Frequency	42 V3 - 200Hz	42 V3 - 200Hz	42 V3 - 200Hz
RN 38	2	4	-
RN 58	2	4	-
RN 65	2	4	-
SWIFT 14			4

SPECIFICATION

Model Name	Raptor 225	Raptor 325
Length	53 mm	53 mm
Width	31 mm	31 mm
Height	18 mm	18 mm
Weight	15 Kgs	15 Kgs
Cable	10 Mtrs	10 Mtrs
Ports	2-Ports	3-Ports
Power	2.7 kW	2.7 kW
Current	12 A	12 A
Voltage	230 V	230 V
Power	2.5 kW	2.5 kW
Current	35 A	35 A
Voltage	42 V3-200Hz	42 V3-200Hz



RN SERIES POKERS

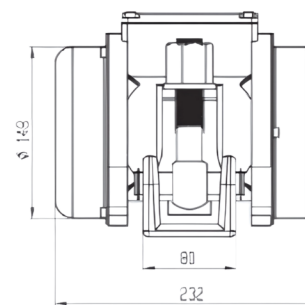
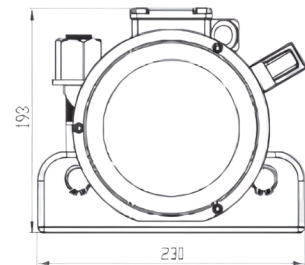

SPECIFICATION

Model Name	RN38	RN58	RN65
Diameter	38	58	65
Length	370 mm	370 mm	370 mm
Weight	12 Kgs	15 Kgs	18 Kgs
Hose	5, 12, 16 mtrs	5, 12, 16 mtrs	5, 12, 16 mtrs
Cable	12 Mtrs	12 Mtrs	15 Mtrs
Current	12 A	15 A	18 A
Performance	20	35	40

Model Name	SWIFT 14
Current	18.2 A
Voltage	42 V
Frequency	200 Hz
Output	1.1 kW
Phase	3 Phase
Vibrations	6000 rpm, 100 Hz
Centrifugal Force	14.14 kN
Weight with Cradle	23.1 Kg
Motor Tupe	High Frequency Cage Motor
Protection	IP 66
Class Rating	III
Storage Temperature	-30 - 70C
Operating Temperature	-10 - 50C
External Temperature	80 C
Sound Level	777.4 db

SHUTTER VIBRATOR

PLUG & PLAY HIGH-FREQUENCY POKERS / VIBRATORS

FALCON



RAVEN



SPECIFICATION

Model Name	FALCON 38	FALCON 58	FALCON 65
Diameter	38	58	65
Length	370 mm	420 mm	400 mm
Weight	14.6 Kgs	20.6 Kgs	22 Kgs
Hose	5, 12, 16 mtrs	5, 12, 16 mtrs	5, 12, 16 mtrs
Cable	12 Mtrs	12 Mtrs	15 Mtrs
Current	.75 A	1.5 A	1.9 A
Performance M3/h	20	35	40

SPECIFICATION

Model Name	RAVEN 38	RAVEN 60
Diameter	38	58
Length	370 mm	420 mm
Weight	14.6Kgs	20.6 Kgs
Hose	5, 12, 16 mtrs	5, 12, 16 mtrs
Cable	12 Mtrs	12 Mtrs
Current	.75 A	1.5 A
Performance M3/h	20	35

Our range of internal vibrators offers exceptional flexibility and ease of handling. With an economically viable design and reliable performance even under fluctuating input voltage, it stands out as our star product.

COMPACTION SOLUTION

PLATE COMPACTOR



GROOVE CUTTER / ROAD CUTTING MACHINE



SPECIFICATION

Model Name	PC20 D	PC16 P	PC16 E
Prime Mover	Greaves Diesel	Honda Petrol Engine	Electric Motor
Engine / Motor	1520 5Hp	GX160 5Hp	ABB / CG / Siemens
Starter Mechanism	Rope Start	Rope Start	DOL Starter - Electric
Centrifugal Force	20 KN	16 KN	16 KN
Travel Speed	24mtrs / hr	24mtrs / hr	24mtrs / hr
Motion Type	Forward	Forward	Forward
Fuel Consumption	220gms/hp/hr	220gms/hp/hr	-
Base Plate	Cohesive Plate 6mm + 25mm Center Plate	Cohesive Plate 6mm + 25mm Center Plate	Cohesive Plate 6mm + 25mm Center Plate
Dimensions LWH	540 x 440 x 810mm	540 x 440 x 630mm	540 x 440 x 630mm
Machine Weight	125 kgs	110 kgs	125 kgs

SPECIFICATION

Model Name	RC E	RC P	RC D
Prime Mover	Crompton/ABB	Honda Petrol Engine	Kohler
Engine / Motor	5 Hp	GX390 13Hp	KD441 10Hp
Starter Mechanism	DOL Starter Electrical	Electric Starter	Electric Starter
Blade Size	350 - 500mm	350 - 500mm	350 - 500mm
Maximum Cutting Depth	180 mm	200 mm	200 mm
Water Tank Capacity	30 Ltrs	30 Ltrs	30 Ltrs
Fuel Consumption	Variable	2 Ltrs/hr	2 Ltrs/hr
Machine Weight	150 Kgs	155 Kgs	165 Kgs

WALK BEHIND ROLLERS



Model Name	DDR20 K	DDR20 G	DDR20 P	SDR15 P
Prime Mover	Kohler Diesel Engine	Greaves Diesel Engine	Honda Petrol Engine	Honda Petrol Engine
Engine / Motor	KD441 10Hp	1530 6Hp	GX390 13Hp	GX160 5Hp
Starter Mechanism	Electric / Start	Electric / Recoil Start	Electric / Recoil Start	Recoil Start Only
Centrifugal Force	20 kN	20 kN	20 kN	15 kN
Vibration	Automatic Clutch Drive	Automatic Clutch Drive	Automatic Clutch Drive	Automatic Clutch Drive
Travel Speed	4kms / hr	4kms / hr	4kms / hr	4kms / hr
Motion Type	Forward & Reverse	Forward & Reverse	Forward & Reverse	Forward & Reverse
Drum Width	600 mm	600 mm	600 mm	600 mm (Single Drum)
Fuel Consumption	1.5 Ltr / hr	1.2 - 1.7 Ltr / hr	1.5 - 2 Ltr / hr	1.2 - 1.5 Ltr / hr
Gradeability	30%	30%	30%	30%
Water Tank	30 Ltrs	30 Ltrs	30 Ltrs	30 Ltrs
Drive	Static Hydraulic Drive Unit	Static Hydraulic Drive Unit	Static Hydraulic Drive Unit	Static Hydraulic Drive Unit
Dimensions LWH	1350 x 810 x 1180mm	1350 x 810 x 1180mm	1350 x 810 x 1180mm	970 x 770 x 1070mm
Machine Weight	590 kgs	580 kgs	580 kgs	350 kgs

Remarks

Series of horizontal dotted lines for text entry.

